

New variety for industrial connectors

With the new **revos** POWER contact inserts, Wieland Electric extends its selection of the **revos** industrial connectors by another high performance industrial connector. Thanks to the different specifications of the various models, these connectors cover a wide field of applications and guarantee individual assembly and installation for use in control and power areas of machines and systems.

► Features

- Intended for the BASIC housing family of housing DIN-size 10/10H, 16/16H or 24/24H
- Available in number of poles 4/8, 12/2, 6/12, 8/24 and 6/36
- Current strengths to 80 A



► Contacts

- Select between 6, 8 or 12 contacts for a maximum current of 40 A or 80 A and 2, 4, 12, 24 or 36 contacts for a maximum current of 10 A.

► Connections

- Connection technology: Screw connection, compact axial screw connection or crimp connection
- Wide range of connections in power area (0.14 - 16 mm²) and control area (0.14 - 2.5 mm²)

► Maximum rated voltage

- 230, 400 or 690 V for the power contacts
- 230, 250 or 400 V for the control contacts

► Rugged

- Captive screws
- Designed for an average 500 mating cycles

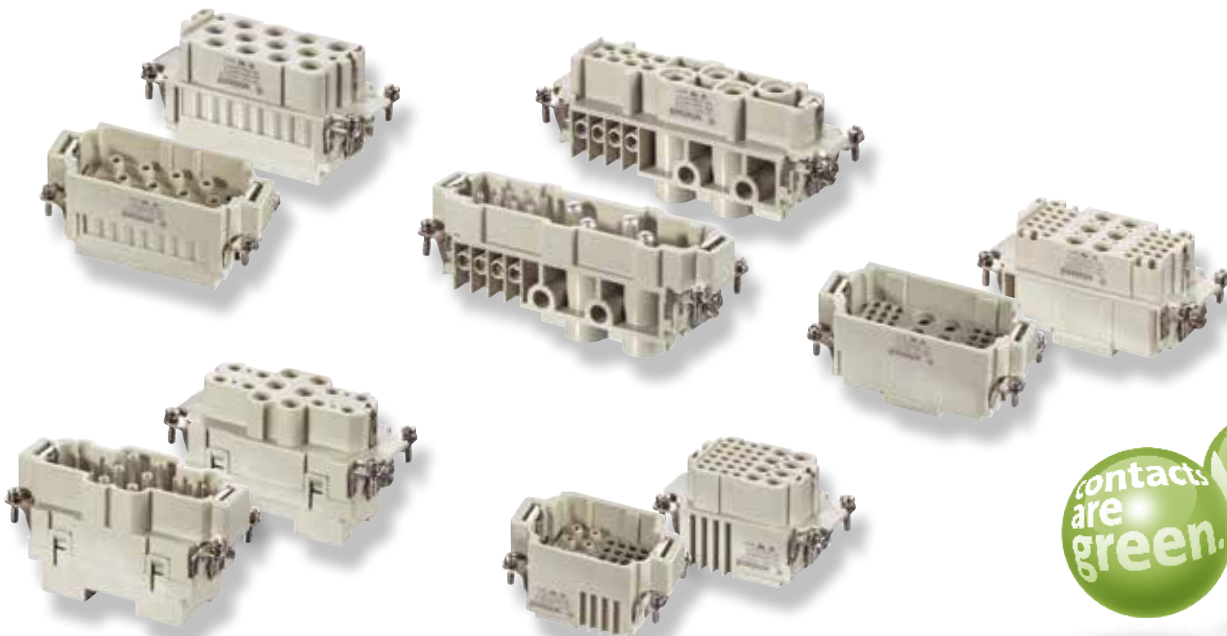

400 V 80 A + 400 V 16 A Contact inserts, screw connection



4-/8-pole + ground
Size 24/24H



System features

- Number of poles: 4 contacts 80 A + 8 contacts 16 A
- Use in **revos**BASIC housings of DIN-size 24/24H in metal design.
- Rated voltage 400 V; as per UL 600 V
- Connection technology: Screw connection
- Connection range: 1.5 – 16 mm²

Note: The protective earth connection must be provided with the respective cable lug for 10 mm² and 16 mm² cross-sections.

Description	Type	Part No.	P.U.				
Contact insert revos^{POWER}							
4-/8-pole + ground							
Male insert	POW STS 4/8 NL BB AG	72.216.1253.0	5				
Female insert	POW BUS 4/8 NL BB AG	72.206.1253.0	5				
Technical data							
Rated voltage	400 V						
Rated voltage according to UL	600 V						
Rated impulse voltage	4 contacts 6 kV / 8 contacts 6 kV						
Rated current	4 contacts 80 A / 8 contacts 16 A						
Degree of pollution	3						
Rated cross section							
EN 60999	4 x 1.5 – 16 mm ² and 8 x 0.5 – 2.5 mm ²						
UL	4 x 16 – 6 AWG and 8 x 20 – 14 AWG						
CSA	–						
Contacts							
Material	Copper alloy						
Surface	Ag						
Insulation strip length	Power contacts 14 mm / control contacts 7.5 mm						
Contact resistance	Power contacts ≤ 0.3 mΩ / control contacts ≤ 1 mΩ						
Mating cycles	500						
Screws head design / recomm. torque							
Mounting screws	4 x M3 / 0.5 Nm						
Ground conductor screws	M5 / 2.0 Nm						
Temperature range	-40 ... +120 °C						
Clamping screws							
Power contacts							
Tightening torque	mm ²	1.5	2.5	4	6	10	16
	Nm	1.2	2	3	3	3	3
Insulation strip length	mm	14					
Control contacts							
Tightening torque	mm ²	0.5 – 2.5					
	Nm	0.5					
Insulation strip length	mm	7.5					
Description	Type	Part No.	P.U.				
Accessories							
Fork cable lug for protective earth connection 10mm ²		06.600.6127.6	10				
Fork cable lug for protective earth connection 16mm ²		06.600.6227.6	10				
Crimping tool		95.101.0800.0	10				
Crimping die for connection range 10mm ²		05.502.2800.0	10				
Crimping die for connection range 16mm ²		05.501.2900.0	10				
Housing revos^{BASIC}							
Size	24/24H	Page (Catalog 0530.1) 182–201					



Dimensions

4-/8-pole + ground

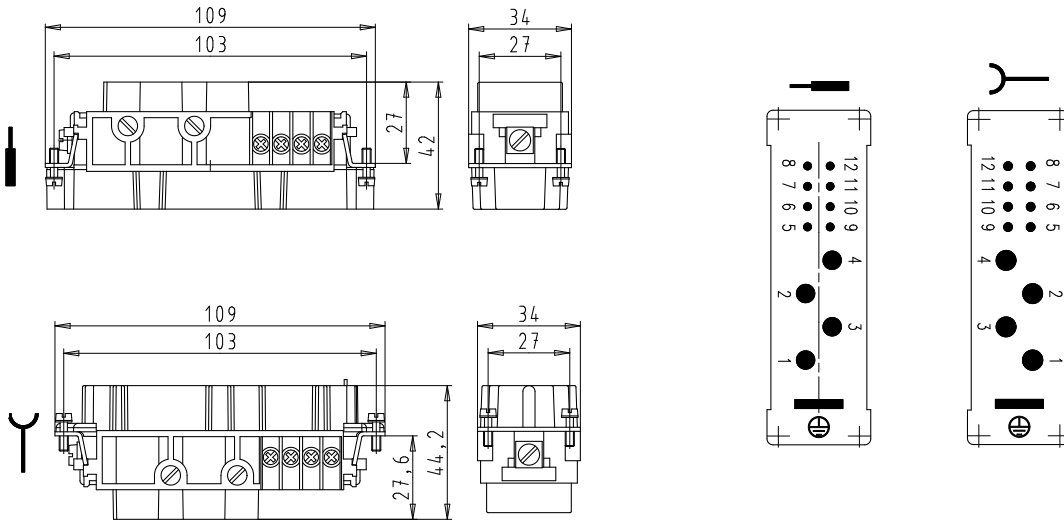

Derating curve – power contacts
 according to IEC 60512 sec. 3
 72.206/216.1253.0 revos POWER
 4-/8-pole / 400 V

- Cross-section 10 mm²
- Cross-section 16 mm²

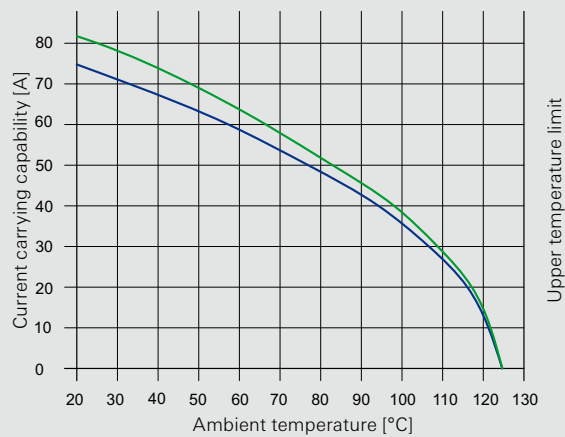

400/690 V 40 A + 230/400 V 10 A

Contact inserts, axial screw / screw connection



6-/12-pole + ground
Size 16/16H

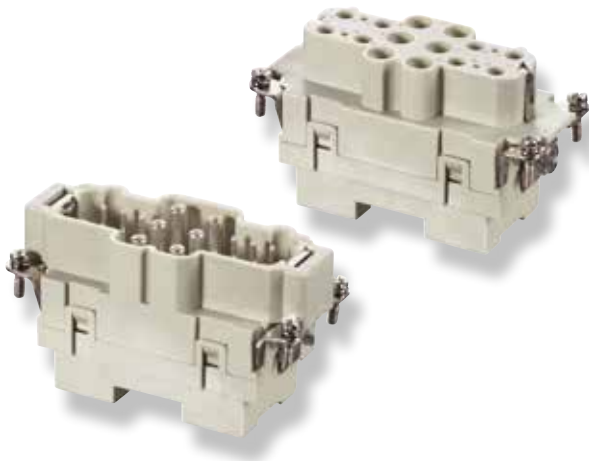

System features

- Number of poles: 6 contacts 40 A + 12 contacts 10 A
- Use in **revos**BASIC housings DIN-size 16/16H in metal design
- Rated voltage:
Power contacts 400/690 V; as per UL 600 V
Control contacts 230/400 V; as per UL 600 V
- Power contacts:
Connection technology: Axial screw connection
Connection range: 2.5 – 6 mm² (variant 1),
6 – 10 mm² (variant 2)
- Control contacts:
Connection technology: Screw connection
Connection range: 0.5 – 25 mm²

Assembly instructions, axial screw connection

1) Open contact chamber and strip wire.

Control contact:

Open contact chamber with slotted screwdriver 0.6x3.5 and strip wire according to rated cross section; lead into rectangular contact chamber.

Power contacts:

Open contact chamber with axial screws on male side. Strip wire according to rated cross section and lead into rectangular contact chamber until the insulation lies flush at the contact. Do not drill wire strands.

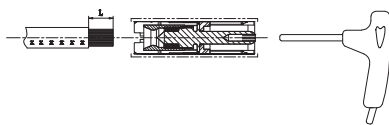

2) Connect contact

Control contact:

Tighten clamping screw with screwdriver 0.6x3.5 with tightening moment 0.8 Nm.

Power contacts:

Hold wire against stop and tighten on male side with axial screwdriver SW 2 to tightening moment listed in table.

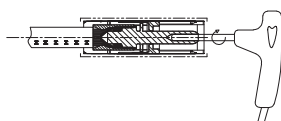

3) Completed connection



Description	Type	Part No.	P.U.		
Contact inserts revos^{POWER}					
6-/12 pole + ground					
Male insert 2.5 – 6 mm ²	POW STS 6/12 KL CA AG	72.215.1853.0	5		
Female insert 2.5 – 6 mm ²	POW BUS 6/12 KL CA AG	72.205.1853.0	5		
Male insert 6 – 10 mm ²	POW STS 6/12 ML CA AG	72.213.1853.0	5		
Female insert 6 – 10 mm ²	POW BUS 6/12 ML CA AG	72.203.1853.0	5		
Technical data					
Rated voltage	L-PE 400 V / L-L 690 V und L-PE 230 V / L-L 400 V				
Rated voltage according to UL	600 V				
Rated impulse voltage	6 contacts 6 kV / 12 contacts 4 kV				
Rated current	6 contacts 40 A / 12 contacts 10 A				
Degree of pollution	3				
Rated cross section					
EN 60999	6 x 2.5 – 10 mm ² and 12 x 0.5 – 2.5 mm ²				
UL	6 x 14 – 8 AWG and 12 x 24 – 14 AWG				
CSA	–				
Contacts					
Material	Copper alloy				
Surface	Ag				
Contact resistance	Power contacts ≤ 0,5 mΩ / control contacts ≤ 3 mΩ				
Mating cycles	500				
Screws head design / recomm. torque					
Mounting screws	4 x M3 / 0,5 Nm				
Ground conductor screws	M5 / 2,0 Nm				
Temperature range	-40 ... +120 °C				
Clamping screws					
Power contacts, fine stranded					
Tightening torque	mm ²	2.5	4	6	10
	Nm	1.5	1.5	2	2
Insulation strip length	mm ²	2.5	4	6	10
	mm	5 ⁺¹	5 ⁺¹	8 ⁺¹	8 ⁺¹
Control contacts					
Tightening torque	mm ²	0.2 – 2.5			
	Nm	0.8			
Insulation strip length	mm	7.5			
Description	Type	Part No.	P.U.		
Accessories					
Axial screwdriver	POW AXIALSHR ISK SW 2	05.502.4500.0	1		
Housing revos^{BASIC}					
Type	Page (Catalog 0530.1)				
Size	16/16H	162–181			

Dimensions

6-/12-pole + ground

Male-/female insert 2.5 – 6 mm²

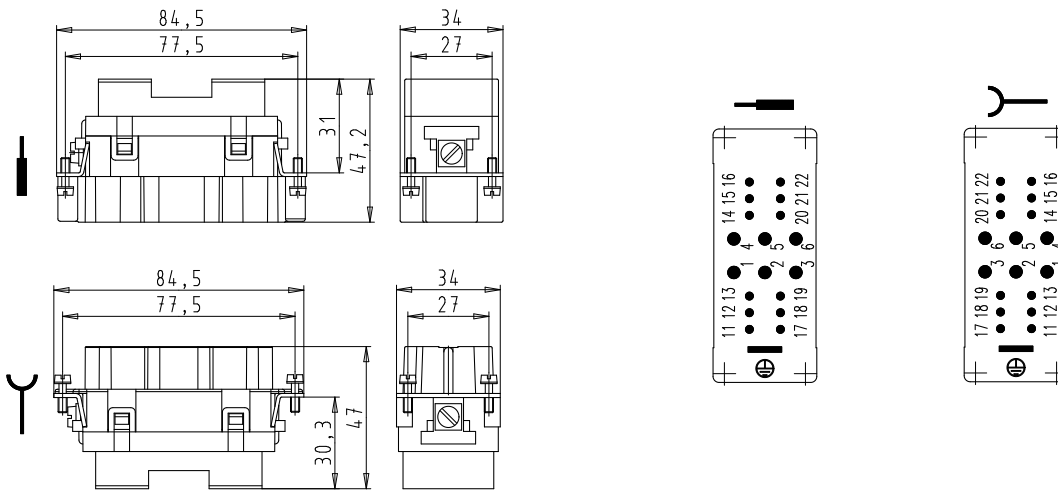

Male-/female insert 6 – 10 mm²

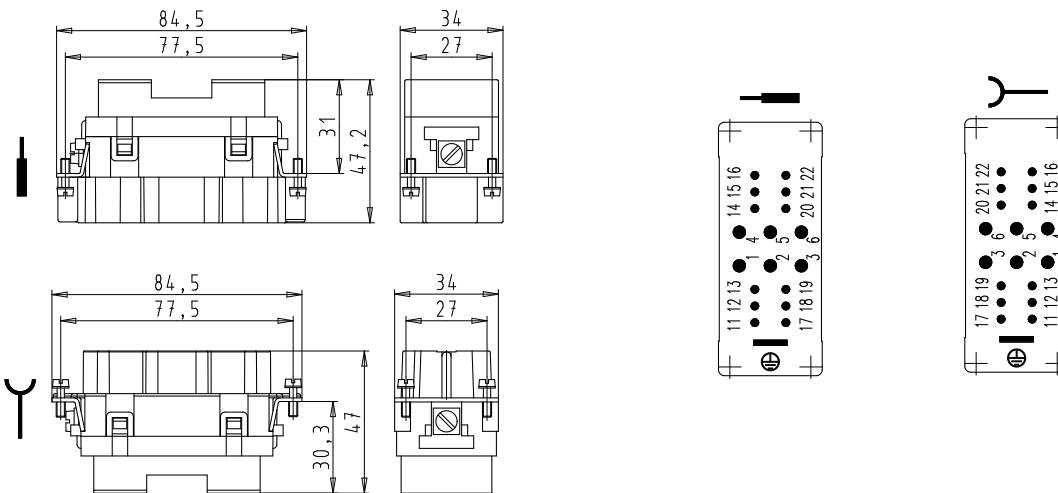

Derating curve – power contacts
 according to IEC 60512 sec. 3
 revos POWER 6-/12-pole
 2.5– 6 mm² / 6 – 10 mm²

- Cross-section 4 mm²
- Cross-section 6 mm²
- Cross-section 10 mm²

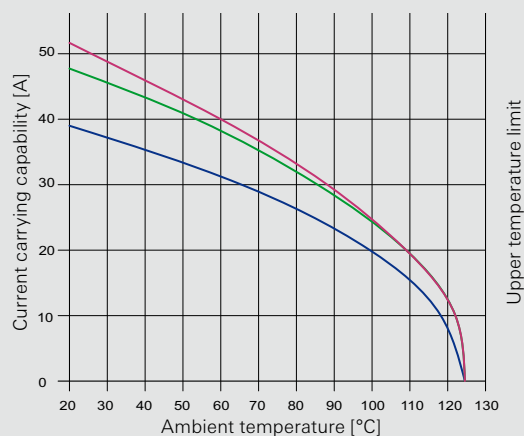

690 V 40 A + 250 V 10 A

Contact inserts, crimp connection



12-/2-pole + ground
Size 16/16H



System features

- Number of poles: 12 contacts 40 A + 2 contacts 10 A
- Use in **revos**BASIC housings of DIN-size 16/16H in metal design
- Rated voltage:
Power contacts 690 V; as per UL/CSA 600 V
Control contacts 250 V; as per UL/CSA 600 V
- Connection technology: Crimp connection
- Connection range:
Power contacts 1.5 – 6 mm²
Control contacts 0.5 – 2,5 mm²

Description	Type	Part No.	P.U.
Contact inserts revos^{POWER}	12-/2-pole + ground		
Male insert	POW STC 12/2 DE	72.713.1453.0	5
Female insert	POW BUC 12/2 DE	72.703.1453.0	5
Contact	mm ² / AWG, turned Ø 4 mm		
Male insert, Ag	1.5 /16	05.545.9200.8	100
Female insert, Ag	1.5 /16	02.126.6700.8	100
Male insert, Ag	2.5 /14	05.545.9300.8	100
Female insert, Ag	2.5 /14	02.126.6800.8	100
Male insert, Ag	4 /12	05.545.9400.8	100
Female insert, Ag	4 /12	02.126.6900.8	100
Male insert, Ag	6 /10	05.545.9500.8	100
Female insert, Ag	6 /10	02.126.7000.8	100
Contact	mm ² / AWG, turned Ø 1,6 mm		
Male insert, Ag	0.14-0.37 /26-22	05.545.7900.8	100
Female insert, Ag	0.14-0.37 /26-22	02.126.5400.8	100
Male insert, Ag	0.5 /20	05.545.8000.8	100
Female insert, Ag	0.5 /20	02.126.5500.8	100
Male insert, Ag	0.75 /18	05.545.8100.8	100
Female insert, Ag	0.75 /18	02.126.5600.8	100
Male insert, Ag	1.0 /18	05.545.8200.8	100
Female insert, Ag	1.0 /18	02.126.5700.8	100
Male insert, Ag	1.5 /16	05.545.8300.8	100
Female insert, Ag	1.5 /16	02.126.5800.8	100
Male insert, Ag	2.5 /14	05.545.8400.8	100
Female insert, Ag	2.5 /14	02.126.5900.8	100
Technical data			
Rated voltage	690 V + 250 V		
Rated voltage according to UL/CSA	600 V		
Rated impulse voltage	12 contacts 8 kV/ 2 contacts 4 kV		
Rated current	12 contacts 40 A/ 2 contacts 10 A		
Degree of pollution	3		
Rated cross section			
EN 60999	12 x 1.5 – 6 mm ² + 2 x 0.14 – 2.5 mm ²		
UL	12 x 16 – 10 AWG + 2 x 26 – 14 AWG		
CSA	12 x 16 – 10 AWG + 2 x 26 – 14 AWG		
Contacts			
Material	Kupferlegierung		
Surface	Ag		
Insulation strip length	Power contacts ≤ 0.3 mΩ / control contacts ≤ 3 mΩ		
Mating cycles	500		
Screws			
	head design / recomb. torque		
Mounting screws	4 x M3 / 0.5 Nm		
Ground conductor screws	M5 / 2.0 Nm		
Temperature range	-40 ... +120 °C		



Dimensions

12-/2-pole + ground

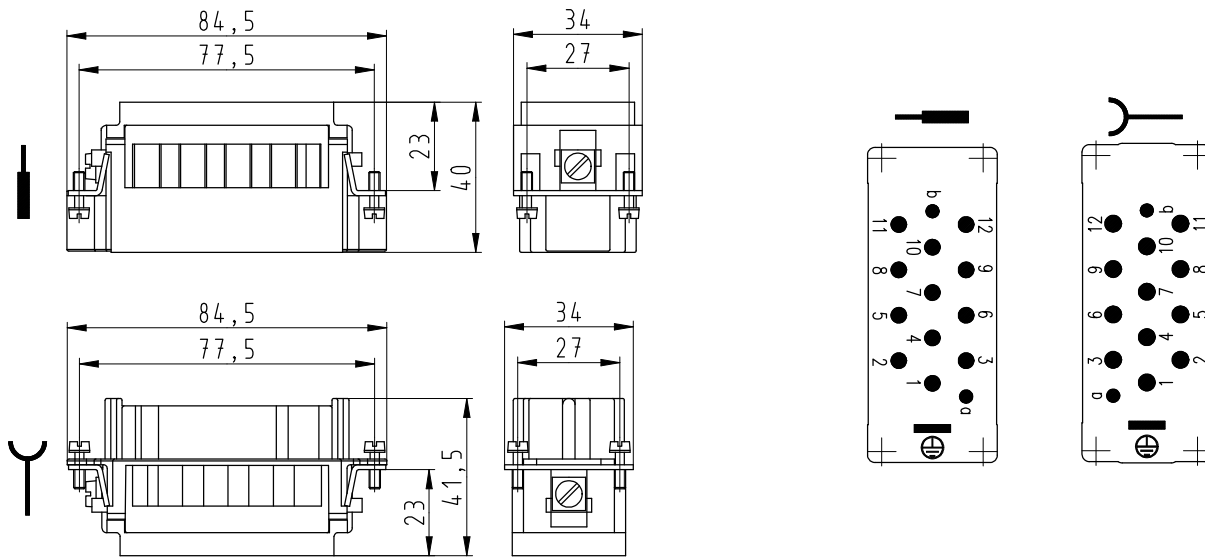

Description	Type	Part No.	P.U.
Accessories			
Crimping tool		95.101.0800.0	1
Crimping die for power contacts	„H“	05.502.5000.0	1
Contacting for power contacts	„6“	05.502.5200.0	1
Crimping die for control contacts	„G“	05.502.4900.0	1
Contacting for control contacts	„5“	05.502.5100.0	1
Extraction tool for crimp contacts	40 A / Ø 4 mm	05.502.4400.0	1
Extraction tool for crimp contacts	10 A / Ø 1.6 mm	05.502.0710.0	1
Housing revos BASIC			
Size	16/16H	Page (Catalog 0530.1)	



Derating curve – power contacts
 according to IEC 60512 sec 3
 revosPOWER 12-/2-pole

- Cross-section 4 mm²
- Cross-section 6 mm²

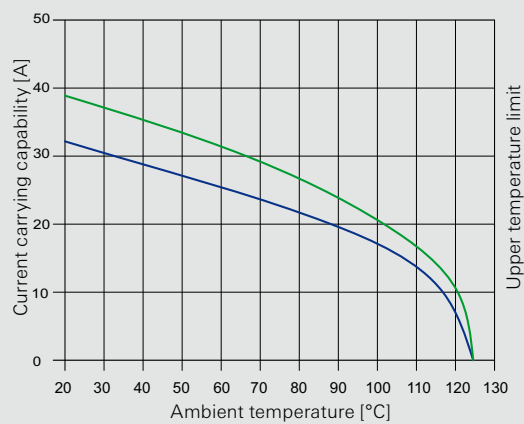

690 V 40 A + 160 V 10 A

Contact inserts, crimp connection



6-/36-pole + ground
Size 16/16H



System features

- Number of poles: 6 contacts 40 A + 36 contacts 10 A
- Use in **revos**BASIC housings of DIN-size 16/16H
- Rated voltage:
Power contacts 690 V; as per UL/CSA 600 V
Control contacts 250 V; as per UL/CSA 600 V
- Connection technology: Crimp connection
- Connection range:
Power contacts 1.5 – 6 mm² (16 – 10 AWG)
Control contacts 0.5 – 2.5 mm² (20 – 14 AWG)

Description	Type	Part No.	P.U.
Contact inserts revos^{POWER}	6-/36-pole + ground		
Male insert	POW STC 6/36 DF	72.713.4253.0	5
Female insert	POW BUC6/36 DF	72.703.4253.0	5
Contacts	mm ² / AWG, turned Ø 4 mm		
Male insert, Ag	1,5 /16	05.545.9200.8	100
Female insert, Ag	1,5 /16	02.126.6700.8	100
Male insert, Ag	2,5 /14	05.545.9300.8	100
Female insert, Ag	2,5 /14	02.126.6800.8	100
Male insert, Ag	4 /12	05.545.9400.8	100
Female insert, Ag	4 /12	02.126.6900.8	100
Male insert, Ag	6 /10	05.545.9500.8	100
Female insert, Ag	6 /10	02.126.7000.8	100
Contacts	mm ² / AWG, turned Ø 1,6 mm		
Male insert, Ag	0,14-0,37 /26-22	05.545.7900.8	100
Female insert, Ag	0,14-0,37 /26-22	02.126.5400.8	100
Male insert, Ag	0,5 /20	05.545.8000.8	100
Female insert, Ag	0,5 /20	02.126.5500.8	100
Male insert, Ag	0,75 /18	05.545.8100.8	100
Female insert, Ag	0,75 /18	02.126.5600.8	100
Male insert, Ag	1,0 /18	05.545.8200.8	100
Female insert, Ag	1,0 /18	02.126.5700.8	100
Male insert, Ag	1,5 /16	05.545.8300.8	100
Female insert, Ag	1,5 /16	02.126.5800.8	100
Male insert, Ag	2,5 /14	05.545.8400.8	100
Female insert, Ag	2,5 /14	02.126.5900.8	100
Technical data			
Rated voltage	690 V + 160 V		
Rated voltage according to UL/CSA	600 V		
Rated impulse voltage	6 contacts 8 kV / 36 contacts 2.5 kV		
Rated current	6 contacts 40 A / 36 contacts 10 A		
Degree of pollution	3		
Rated cross section			
EN 60999	6 x 1,5 – 6 mm ² + 36 x 0.14 – 2.5 mm ²		
UL	6 x 16 – 10 AWG + 36 x 26 – 14 AWG		
CSA	6 x 16 – 10 AWG + 36 x 26 – 14 AWG		
Contacts			
Material	Copper alloy		
Surface	Ag		
Contact resistance	Power contacts ≤ 0.3 mΩ / control contacts ≤ 3 mΩ		
Mating cycles	500		
Screws			
	head design / recomm. torque		
Mounting screws	4 x M3 / 0.5 Nm		
Ground conductor screws	M5 / 2.0 Nm		
Temperature range	-40 ... +120 °C		



Dimensions

6-/36-pole + ground

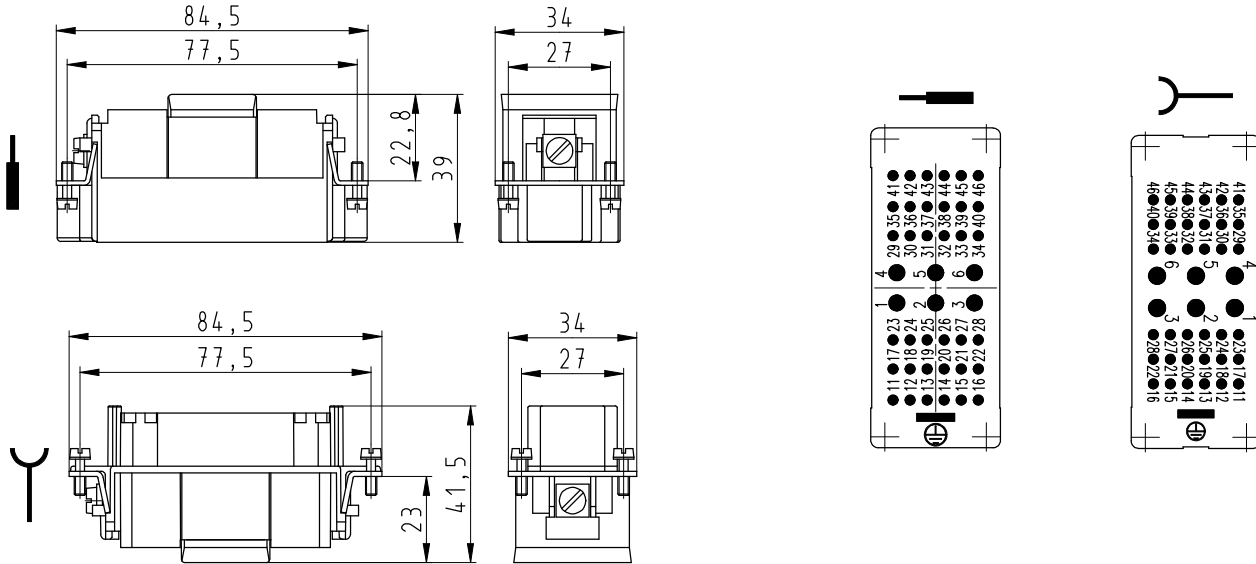

Description	Type	Part No.	P.U.
Accessories			
Crimping tool		95.101.0800.0	1
Crimping die for power contacts	„H“	05.502.5000.0	1
Contact positioner for power contacts	„6“	05.502.5200.0	1
Crimping die for control contacts	„G“	05.502.4900.0	1
Contact positioner for control contacts	„5“	05.502.5100.0	1
Extraction tool for crimp contacts	40 A / Ø 4 mm	05.502.4400.0	1
Extraction tool for crimp contacts	10 A / Ø 1.6 mm	05.502.0710.0	1
Housing revos BASIC			
Size	Type	Page (Catalog 0530.1)	
	16H	164, 168, 174, 176, 180	

Derating curve – power contacts
according to IEC 60512 sec 3
revos^{POWER}
6-/36-pole

- Cross-section 4 mm²
- Cross-section 6 mm²

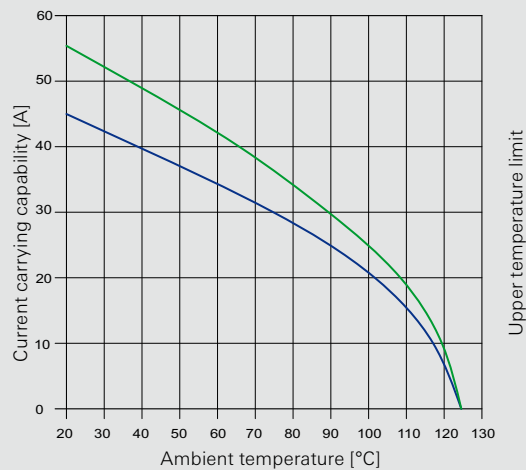

230/400 V 16 A + 250 V 10 A

Contact inserts, crimp connection



8-/24-pole + ground
Size 10/10H



System features

- Number of poles: 8 contacts 16 A + 24 contacts 10 A
- Use in **revos**BASIC housings of DIN-size 10/10H
- Rated voltage:
Power contacts 230/400 V; as per UL 600 V
Control contacts 250 V; as per UL 600 V
- Connection technology: Crimp connection
- Connection range:
Power contacts 0.14 – 4 mm²
Control contacts 0.14 – 2.5 mm²

Disassembling the power contacts

- 1) Insert screwdriver (size 0 DIN ISO 8764-1-PH) up until stop in opening of the contact to be disassembled.
- 2) Pull contact out of the contact insert by its wire.

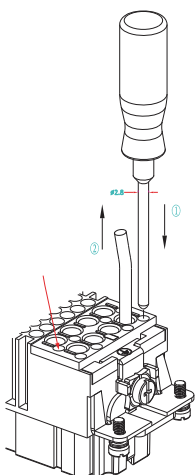

Description	Type	Part No.	P.U.
Contact inserts revos^{POWER}			
8-/24-pole + ground			
Male insert	POW STC 8/24 AF	72.713.3253.0	5
Female insert	POW BUC 8/24 AF	72.703.3253.0	5
Contacts			
	mm ² / AWG, turned Ø 4 mm		
Male insert, Ag	0.14-0.37 /26-22	05.545.8500.8	100
Female insert, Ag	0.14-0.37 /26-22	02.126.6000.8	100
Male insert, Ag	0.5 /20	05.545.8600.8	100
Female insert, Ag	0.5 /20	02.126.6100.8	100
Male insert, Ag	0.75 /18	05.545.8700.8	100
Female insert, Ag	0.75 /18	02.126.6200.8	100
Male insert, Ag	1.0 /18	05.545.8800.8	100
Female insert, Ag	1.0 /18	02.126.6300.8	100
Male insert, Ag	1.5 /16	05.545.8900.8	100
Female insert, Ag	1.5 /16	02.126.6400.8	100
Male insert, Ag	2.5 /14	05.545.9000.8	100
Female insert, Ag	2.5 /14	02.126.6500.8	100
Male insert, Ag	4 /12	05.545.9100.8	100
Female insert, Ag	4 /12	02.126.6600.8	100
Contacts			
	mm ² / AWG, turned Ø 1,6 mm		
Male insert, Ag	0.14-0.37 /26-22	05.545.7900.8	100
Female insert, Ag	0.14-0.37 /26-22	02.126.5400.8	100
Male insert, Ag	0.5 /20	05.545.7900.8	100
Female insert, Ag	0.5 /20	02.126.5500.8	100
Male insert, Ag	0.75 /18	05.545.7900.8	100
Female insert, Ag	0.75 /18	02.126.5600.8	100
Male insert, Ag	1.0 /18	05.545.7900.8	100
Female insert, Ag	1.0 /18	02.126.5700.8	100
Male insert, Ag	1.5 /16	05.545.7900.8	100
Female insert, Ag	1.5 /16	02.126.5400.8	100
Male insert, Ag	2.5 /14	05.545.7900.8	100
Female insert, Ag	2.5 /14	02.126.5400.8	100

Technical data

Rated voltage power / control contacts	p.c.: L-PE 230 V / L-L 400 V, c.c.: 160 V
Rated voltage according to UL/CSA	600 V/300 V
Rated impulse voltage	8 Contacts 4 kV / 24 Contacts 2.5 kV
Rated current	8 Contacts 16 A / 24 Contacts 10 A
Degree of pollution	3

Rated cross section

EN 60999	8 x 0,5 - 4 mm ² + 24 x 0,14 - 2,5mm ²
UL	8 x 20 - 12 AWG + 24 x 26 - 14 AWG
CSA	-

Contacts

Material	Copper alloy
Surface	Ag
Contact resistance	Power contacts 7.5 mΩ / Control contacts 8 mΩ
Mating cycles	500

Screws

Mounting screws	4 x M3 / 0.5 Nm
Ground conductor screws	M5 / 2.0 Nm
Temperature range	-40 ... +120 °C

Dimensions

8-/24-pole + ground

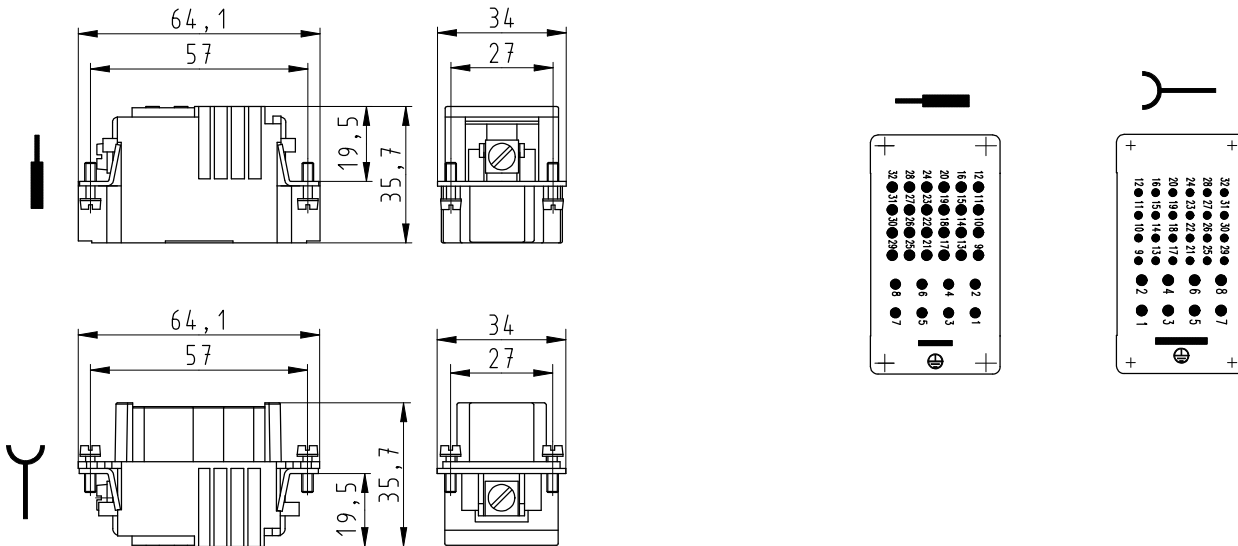

Description	Type	Part No.	P.U.
Accessories			
Crimping tool		95.101.0800.0	1
Crimping die for power contacts	„B“	05.502.5000.0	1
Contact positioner for power contacts	„3“	05.502.5200.0	1
Crimping die for control contacts	„G“	05.502.4900.0	1
Contact positioner for control contacts	„5“	05.502.5100.0	1
Extraction tool for crimp contacts	16 A / Ø 2.5 mm	05.502.4400.0	1
Extraction tool for crimp contacts	10 A / Ø 1.6 mm	05.502.0710.0	1
Screw driver	1750 PH 0x60 031219	06.502.4900.0	1
Housing revos BASIC			
Size	10/10H	Page (Catalog 0530.1)	

Derating curve – power contacts
 according to IEC 60512 sec 3
 revos^{POWER}
 6-/36-pole

- Cross-section 4 mm²
- Cross-section 6 mm²

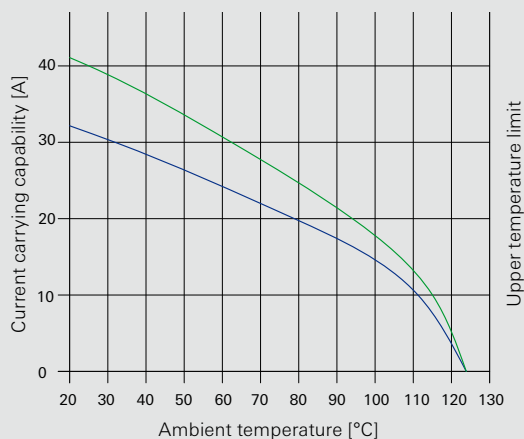



wieland

Headquarters:
Wieland Electric GmbH
Brennerstraße 10 – 14
96052 Bamberg, Germany

Sales Center:
Wieland Electric GmbH
Benzstraße 9
96052 Bamberg, Germany

Phone +49 951 93 24-0
Fax +49 951 93 24-198
www.wieland-electric.com
info@wieland-electric.com

Industrial technology

Solutions for the control cabinet

- DIN rail terminal blocks
 - Screw, tension spring or push-in connection technology
 - Wire cross sections up to 300 mm²
 - Numerous special functions
 - Software solutions interfacing to CAE systems
- Safety
 - Safe signal acquisition
 - Safety switching devices
 - Modular safety modules
 - Compact safety controllers
 - Application consulting and training
- Network engineering and fieldbus systems
 - Remote maintenance via VPN industrial router and VPN service portal
 - Industrial Ethernet switches
 - PLC and I/O systems, standard and increased environmental conditions
- Interface
 - Power supply units
 - Overvoltage protection
 - Coupling relays, semiconductor switches
 - Timer relays, measuring and monitoring relays
 - Analog coupling and converter modules
 - Passive interfaces

Solutions for field applications

- Decentralized installation and automation technology
 - Electrical installation for wind tower
 - Fieldbus interfaces and motor starters
- Connectors for industrial applications
 - Rectangular and round connectors
 - Aluminum or plastic housings
 - Degree of protection up to IP69K
 - Current-carrying capacity up to 100 A
 - Connectors for hazardous areas
 - Modular, application-specific technology

PC board terminals and connectors

- Screw or spring clamp connection technology
- Spacings: 3.5 mm to 10.16 mm
- Reflow or wave soldering process

Building and installation technology

- Building installation systems
 - Main power supply connectors IP20/ IP65... IP69K
 - Bus connectors
 - Low-voltage connectors
 - Power distribution system with flat cables
 - Distribution systems
 - Room automation with KNX and wireless technology
 - DIN rail terminal blocks for electrical installations
 - Overvoltage protection

Our subsidiaries



USA
Wieland Electric Inc.
North American Headquarters
2889 Brighton Road
Oakville, Ontario L6H 6C9
Phone +1 905 8298414
Fax +1 905 829 413
www.wielandinc.com



CANADA
Wieland Electric Inc.
North American Headquarters
2889 Brighton Road
Oakville, Ontario L6H 6C9
Phone +1 905 8298414
Fax +1 905 829 413
www.wieland-electric.ca



GREAT BRITAIN
Wieland Electric Ltd.
Riverside Business Centre,
Walnut Tree Close
GB Guildford/Surrey GU1 4UG
Phone +44 1483 531213
Fax +44 1483 505029
sales.uk@wieland-electric.com



FRANCE
Wieland Electric SARL.
Le Céramé Hall 6
47, avenue des Genottes
CS 48313,
95803 Cergy-Pontoise Cedex
Phone +33 1 30320707
Fax +33 1 30320717
info.adv@wieland-electric.com



SPAIN
Wieland Electric S.L.
C/ Maria Auxiliadora 2 bajos
E-08017 Barcelona
Phone +34 93 2523820
Fax +34 93 2523825
ventas@wieland-electric.com



ITALY
Wieland Electric S.r.l.
Via Edison, 209
I-20019 Settimo Milanese
Phone +39 02 48 916357
Fax +39 02 48 920685
info.italy@wieland-electric.com



BELGIUM
ATEM-Wieland Electric NV
Bedrijvenpark De Veert 4
B-2830 Willebroek
Phone +32 3 8661800
Fax +32 3 8661828
info.belgium@wieland-electric.com



DENMARK
Wieland Electric A/S
Vallørækken 26
DK-4600 Køge
Phone +45 70 266635
Fax +45 70 266637
sales.denmark@wieland-electric.com



SWITZERLAND
Wieland Electric AG
Harzachstrasse 2b
CH-8404 Winterthur
Phone +41 52 2352100
Fax +41 52 2352119
info.swiss@wieland-electric.com



POLAND
Wieland Electric Sp. Zo.o.
Św. Antoniego 8
62-080 Swadzim
Phone +48 61 2225400
Fax +48 61 8407166
office@wieland-electric.pl



CHINA
Wieland Electric Trading
Unit 2703
International Soho City
889 Renmin Rd., Huang Pu District
PRC-Shanghai 200010
Phone +86 21 63555833
Fax +86 21 63550090
info-shanghai@wieland-electric.com



JAPAN
Wieland Electric Co, Ltd.
Nisso No. 16 Bldg. 7F
3-8-8 Shin-Yokohama,
Kohoku-ku
Yokohama 222-0033
Phone +81 45 473 5085
Fax +81 45 470 5408
info.japan@wieland-electric.com

Sales Partner:

You can reach us worldwide in more than
40 countries. Find the contact address at:
www.wieland-electric.com



Informational brochures for downloading

For technical details use our eCatalog on our website
at <https://eshop.wieland-electric.com>

Subject to technical modifications!
gesis®, **RST**®, **GST**®, **GST18**®, **podis**® and **samos**®
are registered trademarks of Wieland Electric GmbH